



SOUTH POINT

A MASTER PLANNED COMMUNITY

THE DONOVAN R

1,717 SQ FT

3 BEDROOM + OFFICE

2.5 BATHROOM

BASEMENT 836 SQ. FT.

DETACHED GARAGE 19' x 24'

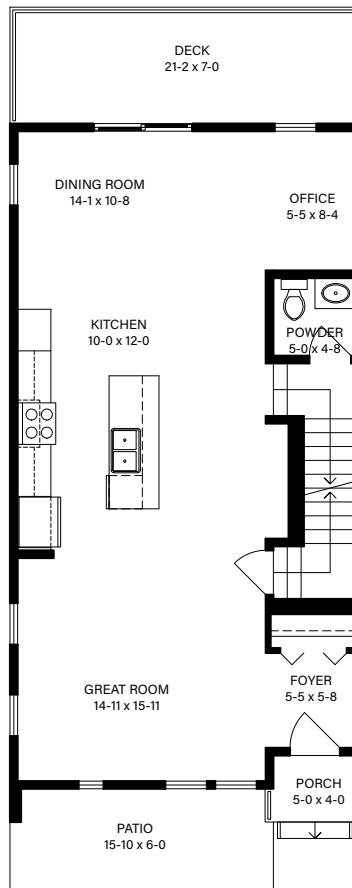

MAIN 836 SQ. FT.

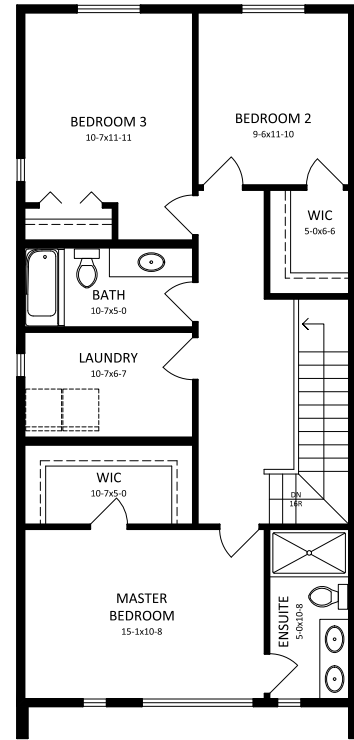

SECOND 881 SQ. FT.

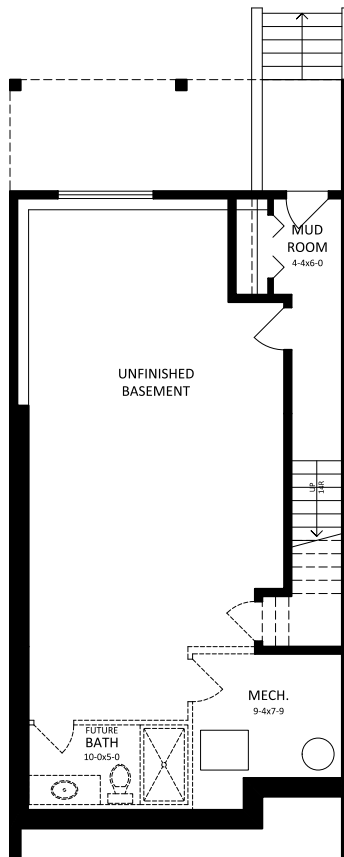

BASEMENT 836 SQ. FT.