



SOUTH POINT

A MASTER PLANNED COMMUNITY

THE DONOVAN W

1,717 SQ. FT.

3 BEDROOM + OFFICE

2.5 BATHROOM

BASEMENT 836 SQ. FT.

DETACHED GARAGE 19' x 24'

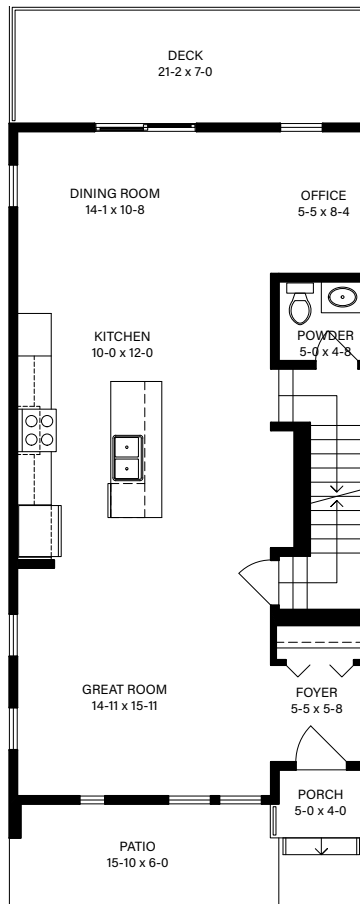

MAIN 836 SQ. FT.

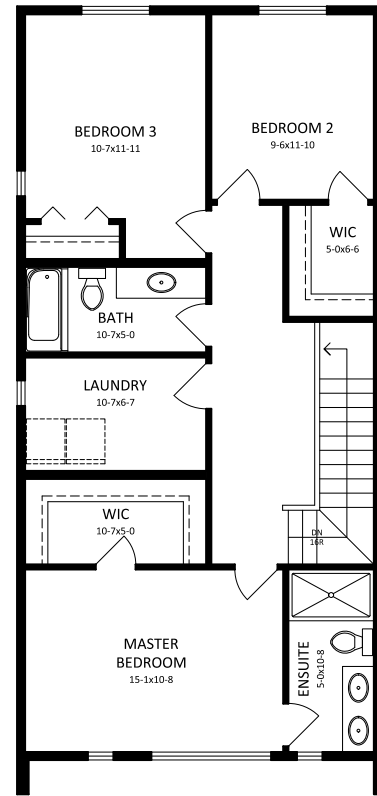

SECOND 881 SQ. FT.

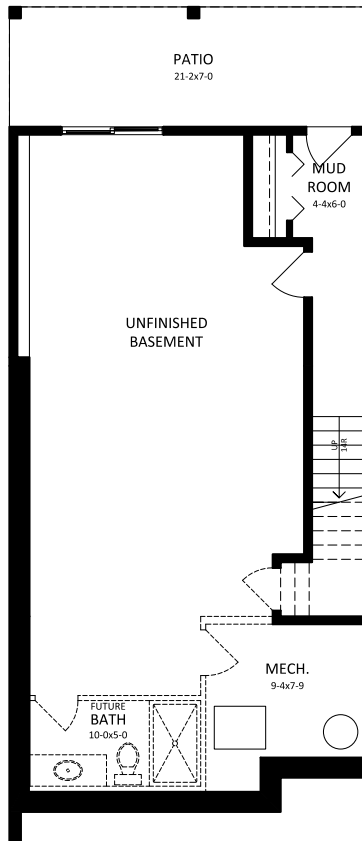

BASEMENT 836 SQ. FT.

The developer reserves the absolute right to modify, cancel or extend this offer at any time without prior notice. Actual interiors, exteriors and views may be noticeably different than what is depicted in photographs. This is not an offering for sale. Any such offering may only be made with the applicable offer to purchase and agreement of sale and disclosure statement. ALL MEASUREMENTS ARE APPROXIMATE. Prices and availability are subject to change without notice. E. & O.E.