

**Basement 226 SQ.FT.**  
**Garage 407 SQ.FT.**

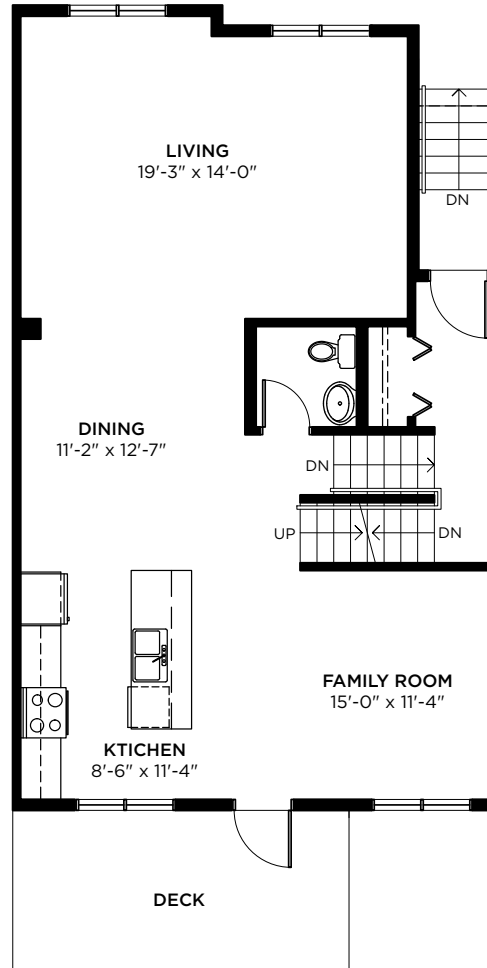

**Main 907 SQ.FT.**

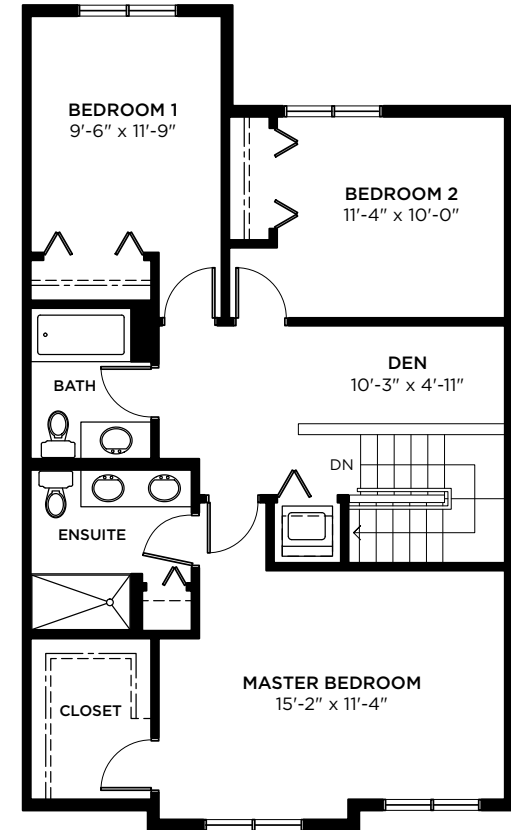

**Second 914 SQ.FT.**

**E**

**TOWNHOME**  
**3 BEDROOM + FLEX + DEN | 3.5 BATHROOM**  
**2,255 SQ.FT.**

In our continuing effort to improve and maintain the high standards of Latimer Heights, Vesta Properties (Latimer) Ltd. reserves the right to modify or change plans, specifications, features and prices without notice. Materials may be substituted with equivalent or better, at Vesta Properties (Latimer) Ltd. sole discretion. All dimensions and sizes are approximate and are based on preliminary survey measurements. As reverse plans occur throughout the development please see architectural plans. E&O.E.

**VESTA**  
PROPERTIES

